



Media Contact:

Javier C. Camacho

Public Relations Specialist

El Paso Electric Company

C: 915.487.4753

javier.camacho@epelectric.com

PRESS RELEASE: March 27, 2020

ROAD CLOSURE: El Paso Electric to Conduct Work for TXDOT Montana Freeway Project
Complete closure along Montana Avenue in East El Paso

EL PASO, Texas – As part of Texas Department of Transportation (TXDOT) continuation of the Montana Freeway Project in east El Paso, El Paso Electric (EPE) will need to complete several electrical wire crossings along Montana Avenue between George Dieter Drive and Lee Boulevard. In order for EPE to safely conduct the necessary work in a timely manner, a complete closure along Montana Avenue will be necessary from 6:00 a.m. till 2:00 p.m. this Sunday, March 29. El Paso Police will be on-site to assist in the closure.

CLOSURE INFORMATION

- **EAST AND WESTBOUND:**
Montana Avenue will be completely closed between George Dieter Drive and Lee Boulevard.
- El Paso Police will be controlling access for any residents or businesses within this closure.

DETOUR INFORMATION

- Traffic traveling along Montana Avenue, east- or westbound, can utilize Turner Road as a detour connected via George Dieter Drive and Lee Boulevard.

TXDOT Montana Freeway Project

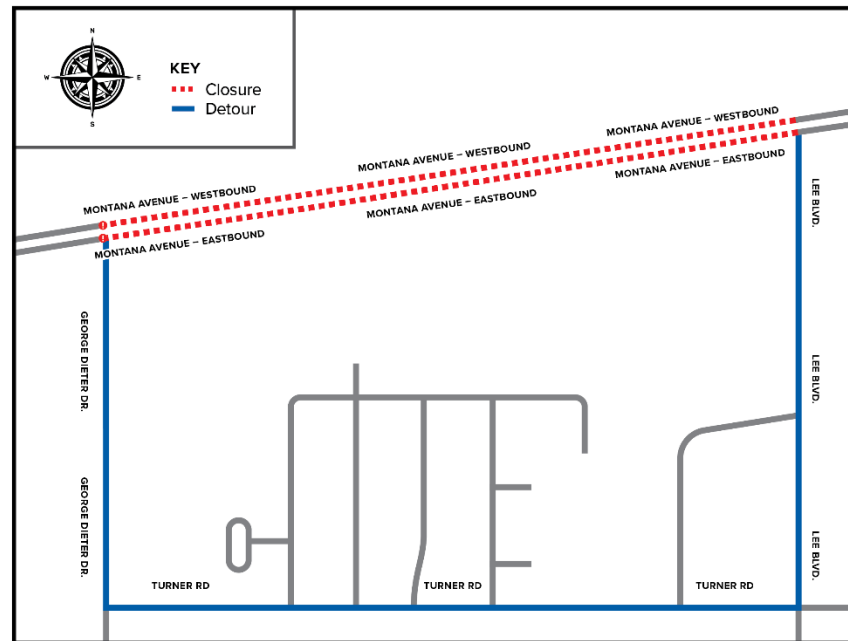

About El Paso Electric

El Paso Electric is a regional electric utility providing generation, transmission and distribution service to approximately 433,000 retail and wholesale customers in a 10,000 square mile area of the Rio Grande valley in west Texas and southern New Mexico.

###

TXDOT Montana Freeway Project

